

For more information about our products visit our websites:

[www.armitage-shanks.co.uk](http://www.armitage-shanks.co.uk)

[www.idealspec.co.uk](http://www.idealspec.co.uk)

[www.fastpart-spares.co.uk](http://www.fastpart-spares.co.uk)



**AFTER SALES NON RESIDENTIAL HELPLINE**  
**0870 122 8822**

**AFTER SALES NON RESIDENTIAL FAX**  
**0870 122 8282**

**E-MAIL**  
**[aftersalesnonresidential@idealstandard.com](mailto:aftersalesnonresidential@idealstandard.com)**

Armitage Shanks pursues a policy of continuing improvement in design and performance of its products.

This right is therefore reserved to vary specification without notice.

Armitage Shanks is a division of  
Ideal Standard (UK) Ltd

Ideal Standard International NV  
Corporate Village - Gent Building  
Da Vincilaan 2  
1935 Zaventem  
Belgium

[www.idealstandardinternational.com](http://www.idealstandardinternational.com)

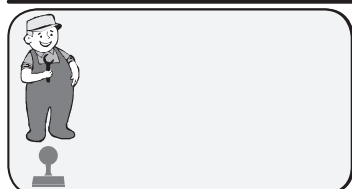

Ideal Standard (UK) Ltd.  
The Bathroom Works  
National Avenue  
Hull HU5 4HS  
England



Ideal Standard International NV  
Corporate Village - Gent Building  
Da Vincilaan 2  
1935 Zaventem  
Belgium



[www.idealstandardinternational.com](http://www.idealstandardinternational.com)

0122 / A 866 780  
Made in Germany

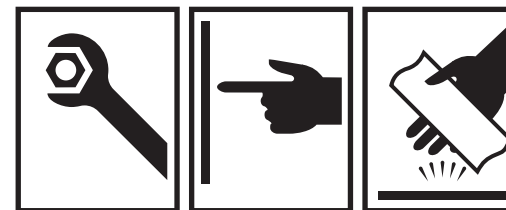

*Armitage  
Shanks*

## Markwik 21+ Safe SQ Protective cover caps kit for sequential thermostatic mixer inlet legs

## INSTALLATION INSTRUCTIONS

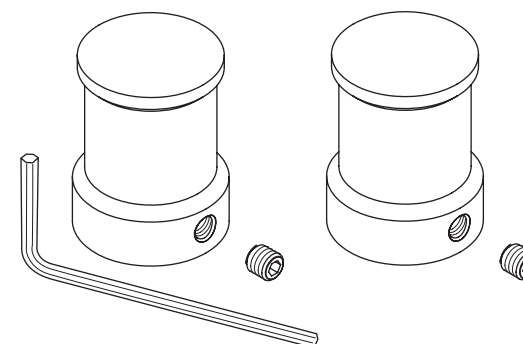

### A6255AA

Protective cover caps kit.

To protect & seal the inlets legs  
when a mixer has been demounted  
& removed.

### Introduction

The designs of Markwik 21+ mixers have been enhanced from 2014 to permit easy demounting of the mixer from the inlets.

This updated design permits quick & easy removal of the mixer for cleaning, disinfection & maintenance purposes.

These protective caps serve as temporary covers to protect the mixer inlets from environmental contamination & should only be used when a replacement mixer is not readily available. The caps will also prevent water escaping if the integral isolating valves are accidentally opened

**FOR MORE DETAILED INFORMATION ABOUT THESE PRODUCTS, REFER TO  
THE MAIN MARKWIK 21+ PRODUCT INSTALLATION BOOKLETS.**

**INSTALLER:** After installation please pass this instruction leaflet to user

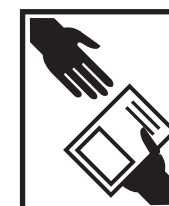

If a replacement mixer is not available, a pair of protective cover caps should be fitted to the inlets.

To prevent environmental contamination of the mixer inlets & for practical / functional reasons the inlets should not be left open.

### Fitting protective cover caps to panel mount mixers

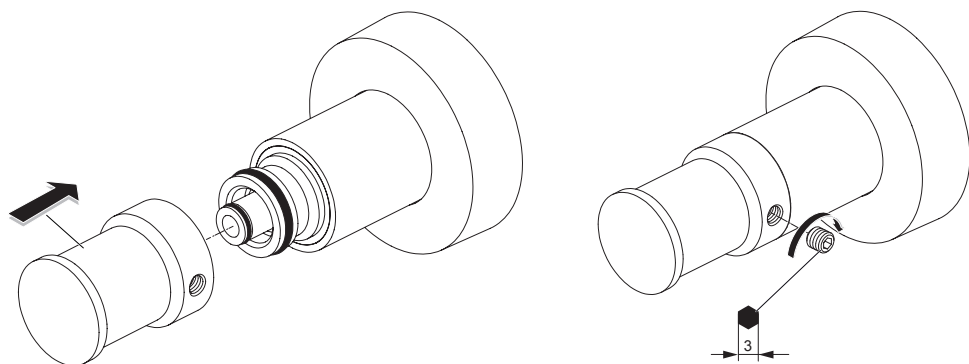

Push the caps onto the inlets until they stop against the shoulder.  
Take care not to damage the o-ring seals.  
Secure the caps with grub screws as shown using a 3mm hexagonal key. Leave the hot & cold supplies isolated.  
Cover caps should be disinfected / sterilised when necessary.

### Fitting protective cover caps to deck mount mixers

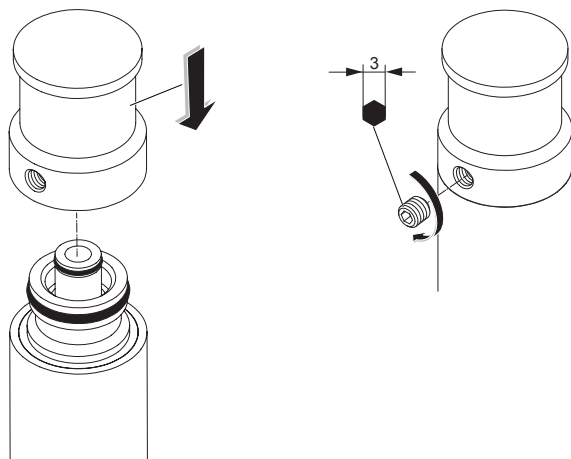

**IMPORTANT:**  
Do not leave the mixer inlets open without a body or cover caps fitted.



Take care to avoid damaging the inlet seals. Damage to these seals would compromise the insulate feature & affect the mixer's thermo-static performance.

### Disinfection

Periodically the protective caps should be disinfected, we recommend parts be immersed in a bactericidal solution.

### Recommended Disinfection Solution

For immersion we recommend the use of a 70% Ethanol solution for 10 minutes.

NB: counter intuitively, **greater than recommended concentrations are less effective** not more effective; take care to get the recommended concentration in line with the manufacturer's recommendation.

### Cleaning chrome surfaces

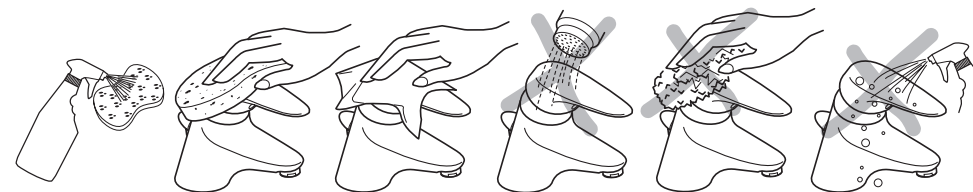

When cleaning chromed products use only a mild detergent, rinse & wipe dry with a soft cloth. Ideally clean after each use to maintain appearance.

Never use abrasive, scouring powders or scrapers. Never use cleaning agents containing ammonia, hydrochloric acid, sulphuric acid, nitric acid, phosphoric acid or organic solvents. Use of incorrect cleaning products / methods may result in chrome damage which is not covered by the manufacturer's guarantee.

For more information about Markwik spares & accessories contact our customer care.